

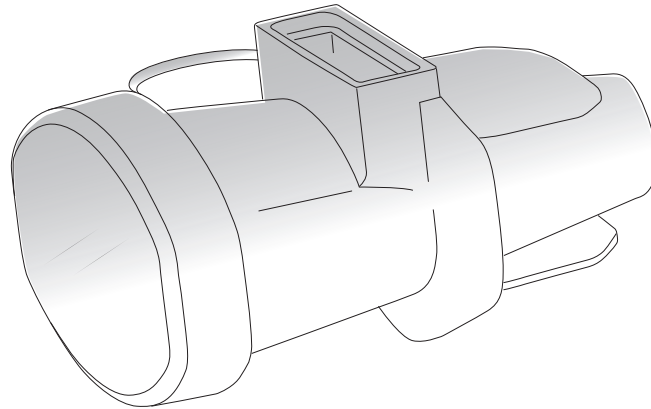

Instructions for Use

For individual patient use.



pMDI attachment
Designed to improve pMDI technique

For more information and animation please visit our website at:
www.flo-tone.com



HS CLEMENT CLARKE
INTERNATIONAL

Tradition and Innovation

 Clement Clarke International Ltd, Edinburgh Way, Harlow, Essex CM20 2TT UK
Tel: +44 (0)1279 414969 Fax: +44 (0)1279 456300 www.clement-clarke.com

Patent pending.

Part no: 1903094

Issue 2 03/16

Contents

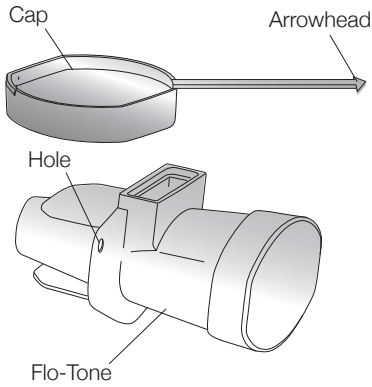

Prepare your Flo-Tone (first use)

To assemble your Flo-Tone:

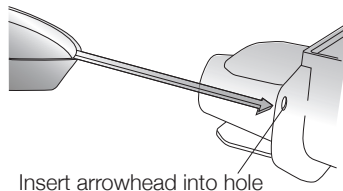

Insert arrowhead into hole on side of Flo-Tone, from behind.

! *This is not a toy.
Danger of small parts.
Choking hazard.*

Intended Use

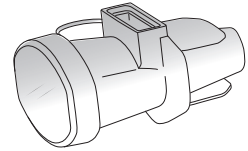

Flo-Tone MDI is a mini-spacer with a training function. It is used to help patients inhale correctly through their pressurised metered dose inhaler (pMDI).

How to prepare your inhaler

1.

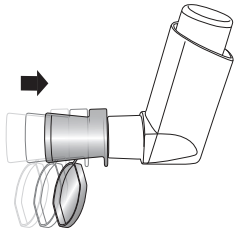

Check the pMDI mouthpiece inside and outside to make sure that it is clean and clear of any loose objects.

Remove Flo-Tone cap and push the **Flo-Tone** firmly in to the end of the pMDI mouthpiece, see above.

2.

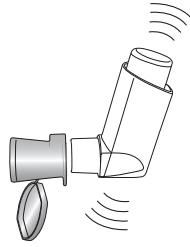

It is important to stand or sit upright when using your inhaler.

Shake the pMDI 4 or 5 times so that the contents of the inhaler are evenly mixed.

Using Flo-Tone with your inhaler

3.

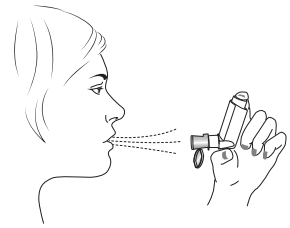

Hold the pMDI upright with your thumb on the base, below the mouthpiece. Breathe out as far as is comfortable. Do not breathe in again yet.

Using Flo-Tone with your inhaler - continued

4.

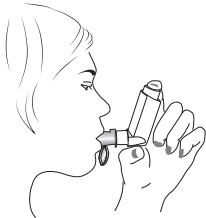

Place the mouthpiece between your teeth. Close your lips around it. Do not bite the mouthpiece. Breathe in through your mouth.

It is important to start to breathe as slowly as possible just before using your inhaler.

5.



Just after starting to breathe in, and when you hear the **Flo-Tone** whistle sound, press down on the top of the canister to release a puff of medicine. Do this while still breathing in steadily and deeply, keeping the whistle going for as long as you can, ideally 4-5 seconds.

6.

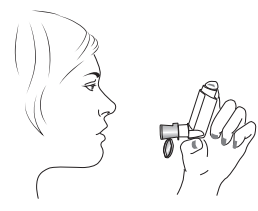

Hold your breath, remove the pMDI from your mouth and your finger from the top of the inhaler. Continue holding your breath for as long as is comfortable.

After use, replace **Flo-Tone** cap.

Continue using **Flo-Tone** to maintain good inhaler technique.

How to look after your Flo-Tone

7.

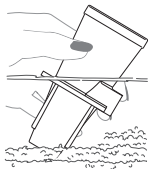

- Wash in warm soapy water, dry thoroughly.
- Dishwasher proof @ 50° cycle, place in dishwasher basket. (Weekly)
- Blow once through the **Flo-Tone** to remove water from the whistle before using again.

With normal daily use the Flo-Tone will last 12 months.

8.

Store **Flo-Tone** in a clean dry place.

Always ensure **Flo-Tone** is dry before use.

You are provided with 2 Flo-Tones so that one is always available if the other is being washed.

Disposal Note: The **Flo-Tone** can be disposed of as normal household waste.

Symbol Explanations



Caution



Consult 'Instructions for Use'



Manufacturer



This product complies with the essential requirements of the medical devices directive (93/42/EEC).