

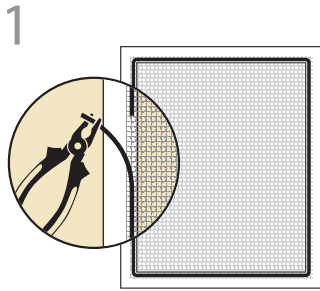

### How to start using RESPILON® Window Membrane?

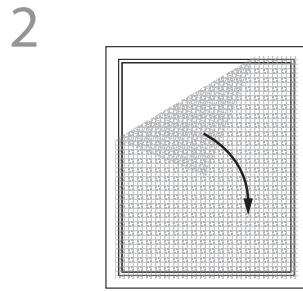

1 Remove the old insulation (weather sealing) from the window screen frame



2 Remove the old window screen from the frame

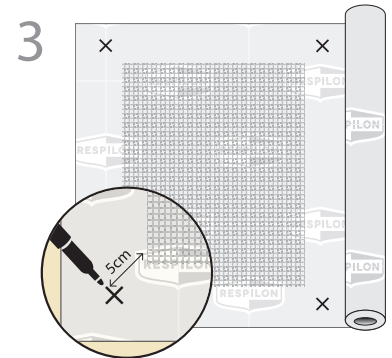

3 Place it on the RESPILON® window membrane and draw four marks approximately 5 cm from the corners of the window screen

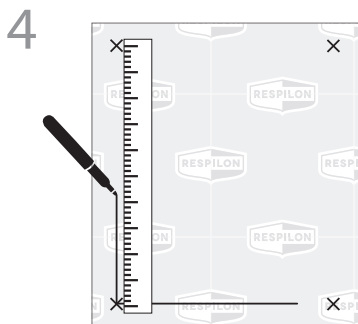

4 Connect the marks to create an outline of the new window screen

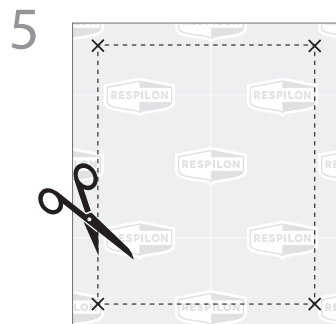

5 Use the outline to cut out the new RESPILON® window screen

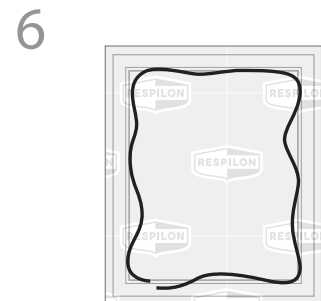

6 Place the RESPILON® window membrane on the frame and prepare the insulation tape (weather sealing)

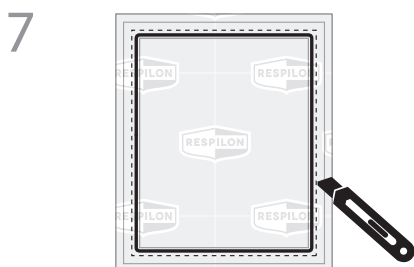

7 Fix the RESPILON® window membrane into the frame using the insulation tape and cut out the excess with a utility knife

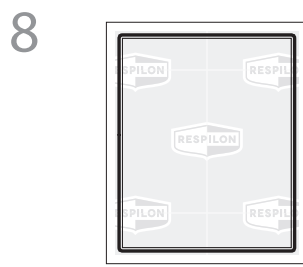

8 Well Done! Now you can place the window screen back on your window or door. RESPILON® retains its filtering properties for up to 3 years. Replace the membrane if it gets mechanically damaged (torn) or markedly dirty.



LIFE'S WORTH IT

**Need help or professional assistance? Contact us on: [technical-support@respilon.com](mailto:technical-support@respilon.com)**